

# Strategy

## I emiliani parking spaces from ground level

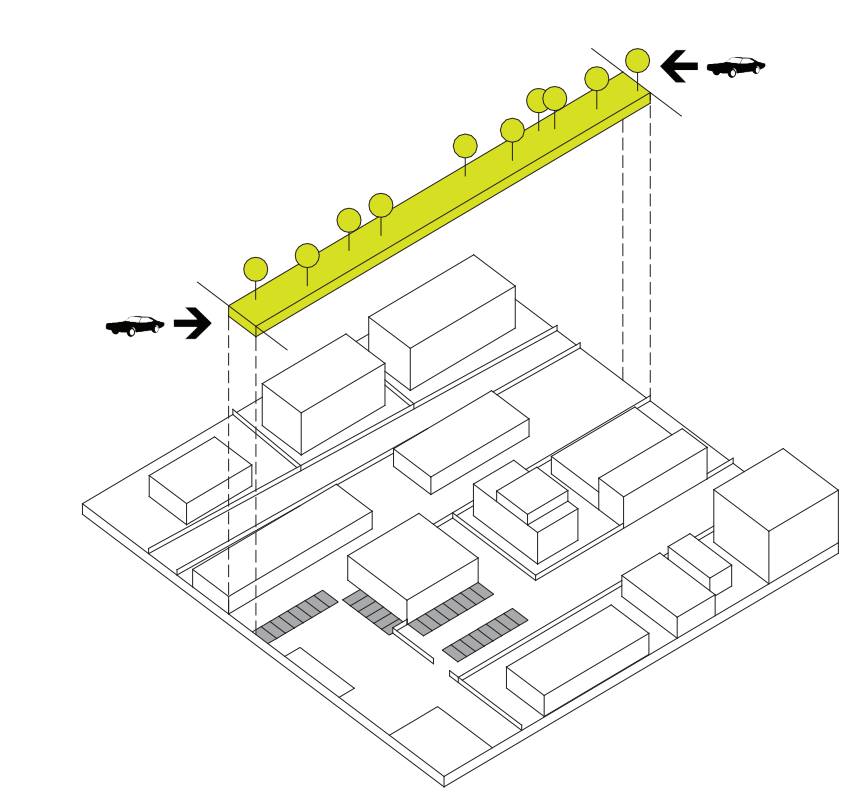

Problem: public spaces are entirely occupied by car park slots for residents and shops.

## III permeability on the ground level. Replacement buildings

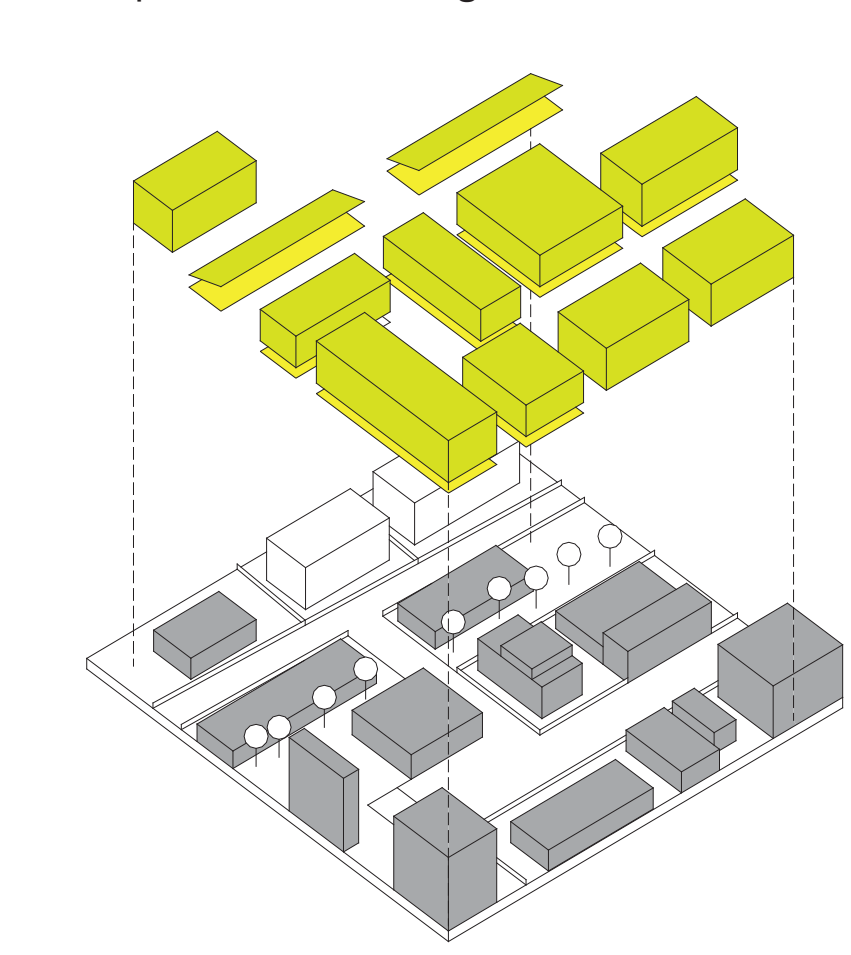

Problem: many existing buildings do not dialogue with the public space that is created between them.

## II opening new passages through the streets. Realization of squares system

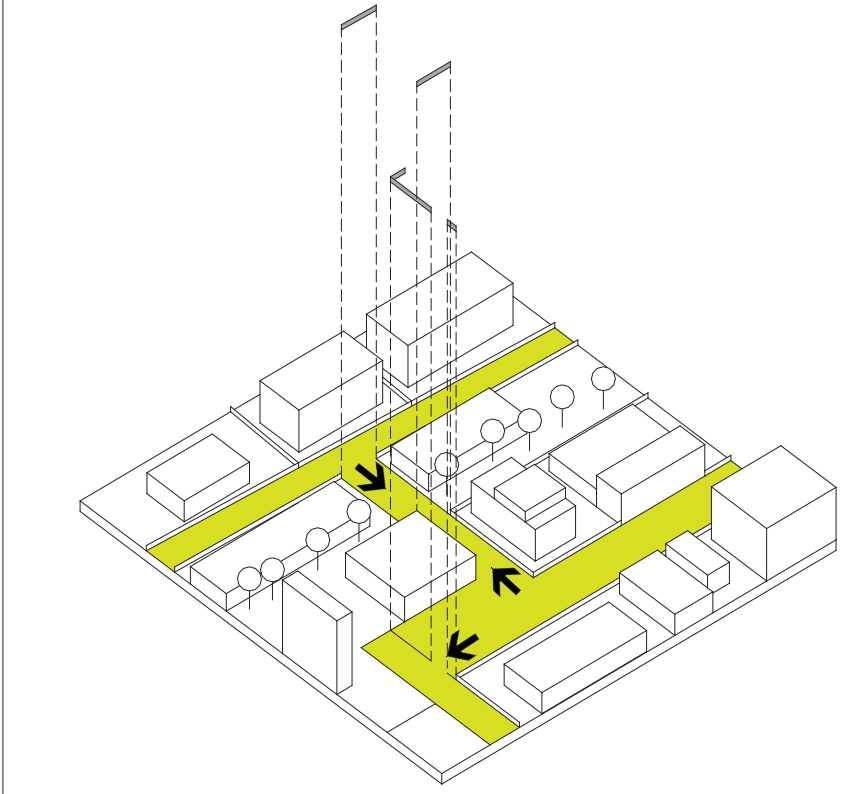

Problem: the streets entering the district are isolated from each other and divide the area in closed compartments that communicate only with Via Emilia.

## IV new system of edges on the ground floor and upper levels

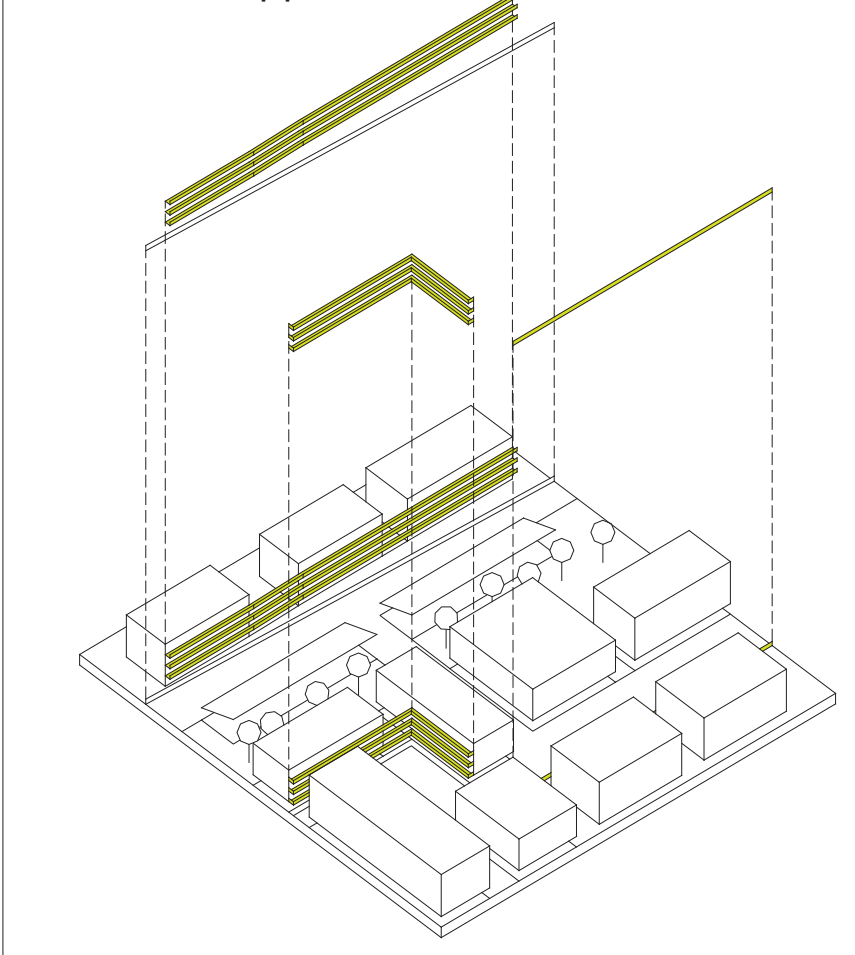

Problem: lack of dialogue between public and private space caused by fences.

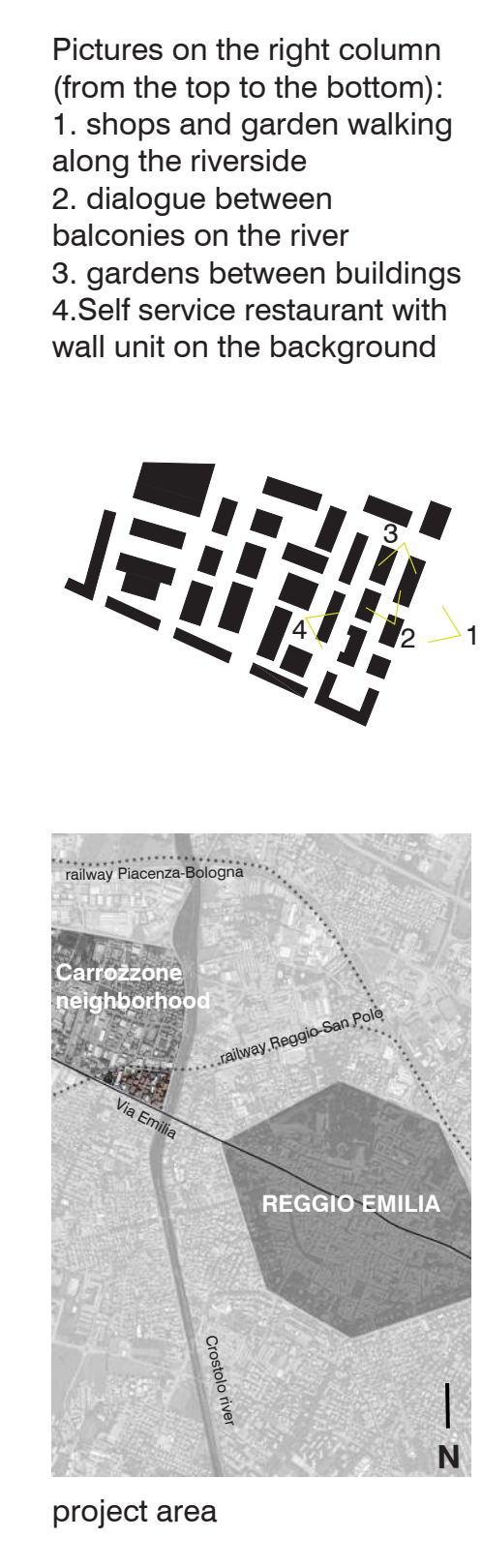

## Typology of actions

**Parking under the garden**

Freedom of movement within the district from parking. The garages in the buildings basement were expanded and connected by an underground road. Above them there are gardens between the buildings.

**Visual permeability**

Ground floors used for commercial activities are equipped with glass walls to allow the view of the gardens behind. In residential buildings visual permeability is guaranteed by the doorways that give direct access to the gardens.

**District rooms**

The extremity of the dead-end streets used now as parking lots are turned into pedestrian areas. The presence of the wall unit system allows people to use these spaces as outdoor rooms.

**Wall units**

In residential buildings, the edge between public and private space is used as a container, open to the street and private gardens. Within this element are placed children toys, street libraries, sport equipments...

**New facade on Via Emilia**

Creation of a new curtain of buildings along Via Emilia. The ground floor with glass walls allows the view inside the area, creating an invitation to enter the district.

**Mobility for tomorrow**

Two of the existing petrol stations are retained while maintaining their function. Organized as exchange points for electric cars, they act as connection points between Via Emilia last circulation and the district pedestrian slow one.

**Balconies**

Buildings are equipped with a system of terraces supported by pilots. These terraces create a new space for direct socialization between the inhabitants and pedestrians.

Assumption of proportional costs for intervention

2015 2020 2030

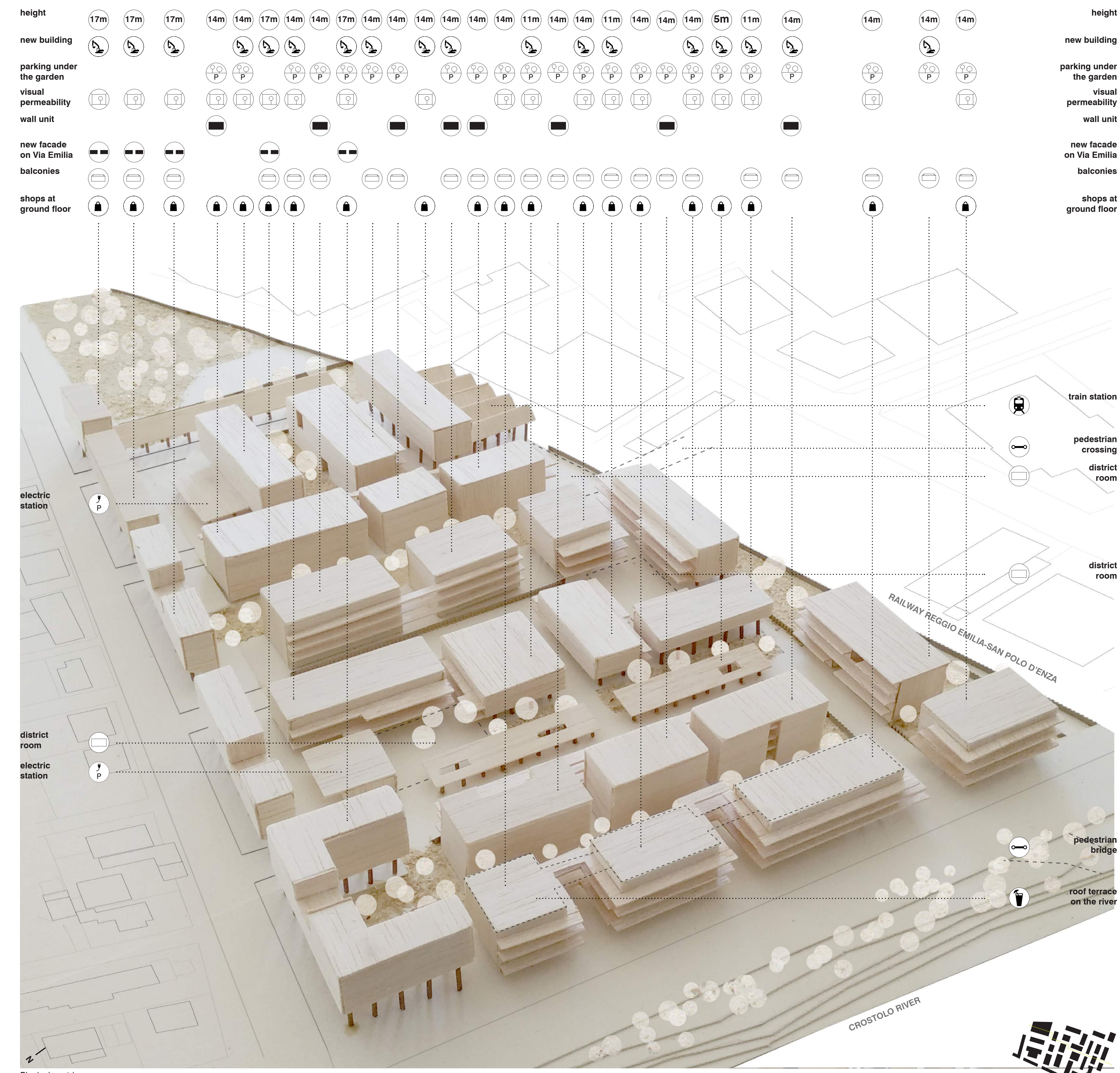

## All the world's a stage

Italy  
Reggio Emilia  
Area Carrazzone  
44°42'N 10°37' E

